

**SS-TS200**  
**SS-TS150**

**½" VOLUME CONTROL**  
**¾" VOLUME CONTROL**

**Note:**

- USE TEFLON TAPE OR PIPE SEALANT FOR THREADED CONNECTIONS
- DO NOT USE PLUMBER'S PUTTY ON ANY OF THE BRASS COMPONENTS  
This will cause the finish to tarnish and void the warranty. A non-corrosive Alkoxy Silicone is recommended.
- DURING SWEATING OF LINES DO NOT OVERHEAT CASTING  
Overheating may cause damage to internal mechanism and void the manufacturer's warranty as well as increase the risk of scalding.
- COPPER ADAPTORS MAY BE REQUIRED TO COMPLETE YOUR INSTALLATION

### DIAGRAM A

Measurements are from the tip of the nipple to the finished wall

| Handle Trim    | Measurement (in.) |
|----------------|-------------------|
| A              | 3                 |
| AA             | 3 1/4             |
| AQ             | 2                 |
| AX             | 3                 |
| AZ1            | 2 1/2             |
| B4/B5          | 3                 |
| B9             | 2 1/8             |
| BB/CC          | 3 1/4             |
| BG4/BG5        | 2 3/4             |
| BL1            | 1 3/8             |
| BL2/BL3        | 1 1/2             |
| BK             | 2 3/4             |
| BV01/BV02/BV09 | 3                 |
| BV05           | 2                 |
| BV13           | 2 1/2             |
| BV81           | 2 1/4             |
| CC11           | 2 1/2             |
| CC20/CC21/CC22 | 2 1/4             |
| CC30/CC31      | 3                 |
| CC40/CC41/CC42 | 2 1/4             |

| Handle Trim | Measurement (in.) |
|-------------|-------------------|
| CC51        | 1 3/4             |
| CC61        | 2 1/2             |
| CL14/CL15   | 2 5/8             |
| CL16        | 2 1/8             |
| CRY4        | 3 1/8             |
| CRY5        | 2 7/8             |
| D           | 3                 |
| D5/D6       | 2 1/2             |
| DD          | 3 1/4             |
| DD2/DD3     | 1 7/8             |
| E/F/G       | 3                 |
| E1 ◆/E2 ◆   | 1                 |
| ED1/ED4     | 1 1/4             |
| ED2/ED3     | 1 3/8             |
| EV4         | 1 7/8             |
| H           | 3 1/4             |
| H4          | 2 1/4             |
| HH/I        | 3                 |
| IN14/IN16   | 3                 |
| J5/J6       | 2 1/2             |

| Handle Trim    | Measurement (in.) |
|----------------|-------------------|
| KK             | 2 1/4             |
| L4/L5/L6/L8    | 1 3/4             |
| L9             | 1 3/4             |
| LLD4/LLP5/LLO6 | 1 3/4             |
| MZ4/MZ5        | 2 7/8             |
| N2/N3/N4       | 2 1/4             |
| N5             | 2 1/2             |
| R1/R2          | 1 1/2             |
| R3             | 2 1/4             |
| RG4/RG5        | 1 5/8             |
| RNK8/RNS4      | 1 3/4             |
| S              | 2 3/4             |
| S1/S1A/S2/S3   | 2 1/4             |
| SA1            | 2 3/4             |
| SA2/SW         | 3                 |
| SP4/SP5        | 2 1/8             |
| T/T1/T4        | 2 1/2             |
| T6/T7/T8/T9    | 3                 |
| TIA/TIB        | 1 3/4             |
| TLS            | 1 3/8             |

| Handle Trim    | Measurement (in.) |
|----------------|-------------------|
| TR14/TR15      | 3                 |
| TR24/TR25      | 2 1/8             |
| U              | 2 1/2             |
| U1             | 3 1/2             |
| U3/U4/U5/U6/U7 | 3 1/4             |
| U8             | 1 3/4             |
| V              | 2 1/4             |
| V1             | 1 1/2             |
| V2/W           | 2                 |
| WA/WB/WC/WD    | 2 1/2             |
| WW             | 3 1/2             |
| X              | 2 3/4             |
| XJ/XM/XN/XO/XQ | 2                 |
| XX             | 3                 |
| Y              | 2 3/4             |
| Y2             | 2 1/4             |
| YY             | 3                 |
| Z              | 2 3/4             |
| ZZ             | 3                 |
| ZEN            | 1 1/8             |

**NOTE: WHEN FITTING HANDLE IT MAY BE NECESSARY TO SHORTEN BROACH STEM AND/ OR THREADED NIPPLE TO MINIMIZE GAP BETWEEN HANDLE AND ESCUTCHEON.**

#### Valve Installation

- Place the valve rough body in position according to mudguard or according to installation Diagram A.
  - **For Diagram A, measure from the tip of the nipple to the finished wall.** Be sure to have additional stem length available in case of extra float for tile, marble or other surface material.
- Sweat lines so that water follows arrow on valves.
- Test valve after it is installed.
  - Run valve for 30 seconds and check for leaks
- Once valve has been tested proceed to close wall up to mudguard (maximum 1 5/8" diameter hole).
- Install Trim.
  - Mount and hand tighten escutcheons to all thread nipples.
  - Install handles on valves. Stems can be cut down if necessary.
    - **NOTE:** For heavier lever handles tighten packing nut (3).

- **NOTE:** Alignment kits are included with most trim to aid in positioning handles horizontally (Diagram D).
- **NOTE:** If valve is set too far in the wall, 1" extension kits may be ordered: Model # SS-EXT20.

**Diagram B**

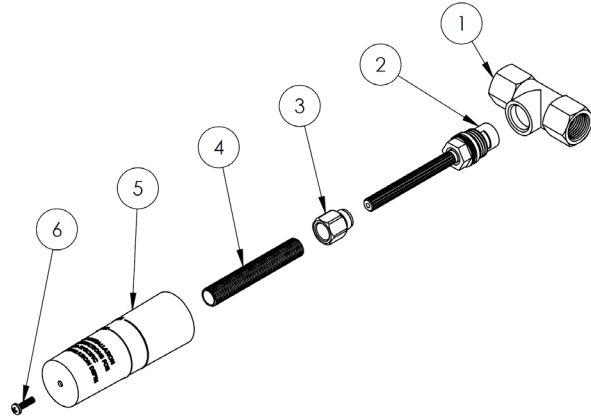

| ITEM NO. | SS-TS200          | SS-TS150          | QTY. |
|----------|-------------------|-------------------|------|
| 1        | SS-TS200 BODY     | SS-TS150 BODY     | 1    |
| 2        | CRT503 Cold/Hot   | CRT-508-TS        | 1    |
| 3        | SS-TS200-PKNG-NUT | SS-TS200-PKNG-NUT | 1    |
| 4        | SS-TS200-NPPL     | SS-TS200-NPPL     | 1    |
| 5        | WALL-VLV-MDGRD    | WALL-VLV-MDGRD    | 1    |
| 6        | MUDGUARD SCREW    | MUDGUARD SCREW    | 1    |

**Diagram C**

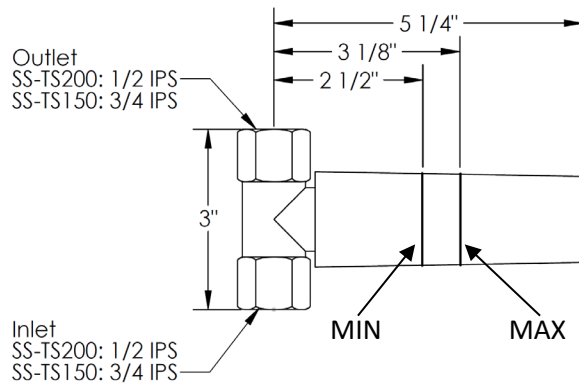

**Diagram D**

